

Sampling / Bleed Valves

An Industry Standard

The sample and bleed valves can be supplied in any number of configurations with options involving body type, end connections and surface finish.

It innovative design capabilities set us apart. The compact and economical design features robust construction, precision machining and state of the art surface finishes with ASME-BPE compliant chemistry. All are machined from 316L austenitic stainless steel bar stock. No castings are used whatsoever, and all are fully traceable with material test reports (MTRs) and heat numbers provided as standard procedure.

Features:

- 316L standard bodies
- optional material alternatives
- single piece stem
- crevice free chamber
- two piece handle
- USP Class VI Seal
- rising stem with central indicator
- no tools necessary- easy maintenance
- less than 1 turn fully open/closed
- simple design and operation

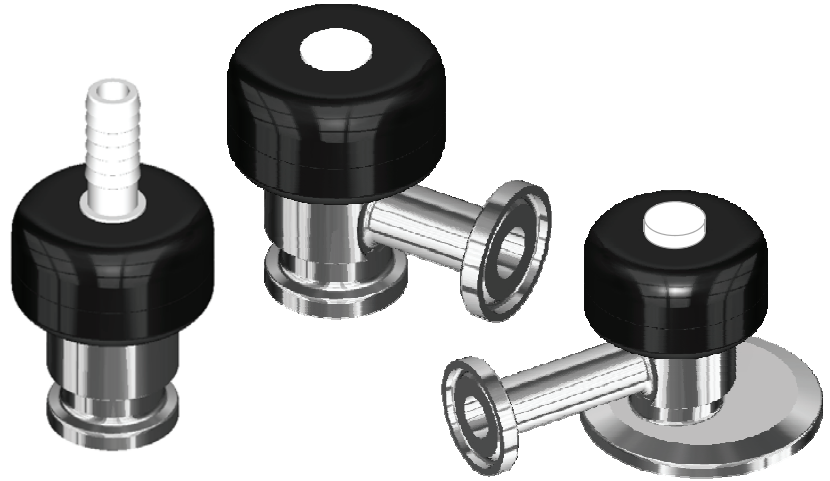

The Difference

Welcome to vision of what a Sample valve should look like. In typical fashion, it revises a tired or flawed original design with improvements that can be evidenced at a glance. With Hybridized options of your liking, we are confident that we can execute your desires for options or further improvements better than any other company. Our integrated manufacturing capabilities ensure that you won't be charged for these improvements the way you might by others. The ARTeSYN™ line of new and improved Sample, Bleed and Pitot valves for clean service, get a look to see what you have been missing.

Applications

- Vent Drain Valve
- Sampling
- Housing / Pump Air Bleed
- Transfer Panel Safety / Drain Valve
- Bleeding systems

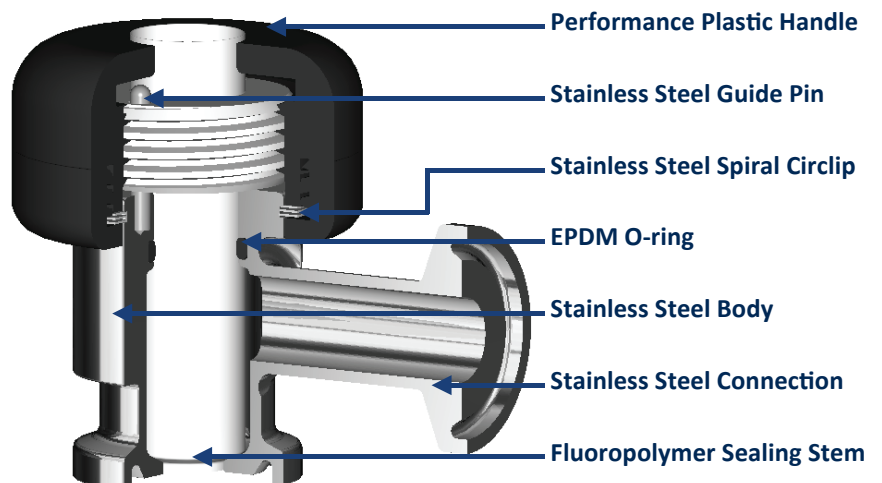

Sampling / Bleed Valves

Part Numbers

Type/ Orientation Options:



SCR
Sample / Bleed Concentric
Right Angle



SER
Sample / Bleed Eccentric
Right Angle



SCI
Sample / Bleed
Concentric Inline



SEI
Sample / Bleed
Eccentric inline

Type	Inlet Orifice	Body Material	Surface Finish	Inlet Connection	Outlet Connection	Seal	Operation
---	---	-	-	--	--	-	--
↓	↓	↓	↓	↓	↓	↓	↓
SCR	06 - .370"	L- SS 316L	1- 10Ra/EP	AC- 1/2" Sanitary Clamp	AA - 1/4" Sanitary Clamp	P -PVDF	16- Manual
SER		H - Kastelloy	2- 15Ra/EP	AD- 3/4" Sanitary Clamp	AB - 3/8" Sanitary Clamp		19- Pneumatic NC
SCI		A- AL6XN		AE- 1" Sanitary Clamp	AC - 1/2" Sanitary Clamp		
SEI				AG- 1 1/2" Sanitary Clamp	HA - 1/4" Hosebarb		
				AH- 2" Sanitary Clamp	HB - 3/8" Hosebarb		
				AJ- 2 1/2" Sanitary Clamp	HC - 1/2" Hosebarb		
				AK- 3" Sanitary Clamp	17 - 1/4" Tubing		
				AL- 4" Sanitary Clamp	18 - 3/8" Tubing		
					09 - 1/2" Tubing		

Example - SER 06 L 2 AE AC P 16

Type	-	Eccentric Sample Valve With Right Angle
Inlet Orifice	-	.370"
Body Material	-	Stainless Steel 316L
Surface Finish	-	15Ra / Electropolished
Inlet Connection	-	1" Sanitary Clamp
Outlet Connection	-	1/2" Sanitary Clamp
Seal	-	PVDF
Operation	-	S/S Manual Bonnet Assembly



SealingSystems

19 Perissou St. 14 343 N.Chalkidona
Athens Greece

Tel. 030 - 2108312002

e-mail: info@sealingsystems.gr

www.sealingsystems.gr